

Tenditori snodati con terminale a pressare
Toggle and swaging terminal

A

Art.	Cavo Wire Ø mm	Filettatura Thread	D Ø mm	Chiuso Closed	L mm	Aperto Open	A mm	Carico di rottura Breaking load Kg
36.39	2,5	5 MA	5	155		215	5	850
36.40	3	6 MA	6	175		245	6	1.500
36.41	4	8 MA	8	200		280	8	2.200
36.42	5	10 MA	10	250		340	10	3.300

Art.	Cavo Wire Ø mm	Filettatura Thread	D Ø mm	Chiuso Closed	L mm	Aperto Open	A mm	Carico di rottura Breaking load Kg
36.49	2,5	5 MA	5	122		182	5	850
36.50	3	6 MA	6	150		220	6	1.500
36.51	4	8 MA	8	180		260	8	2.200
36.52	5	10 MA	10	220		310	10	3.300

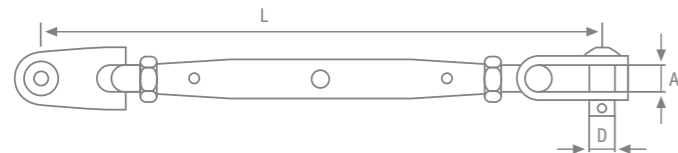

Tenditori snodati a due forcelle
Two toggles

B

C

Art.	Cavo Wire Ø mm	Filettatura Thread	D Ø mm	Chiuso Closed	L mm	Aperto Open	A mm	Carico di rottura Breaking load Kg
36.55	2,5	5 MA	5	140		205	6	850
36.56	3	6 MA	5	160		234	7	1.500
36.58	4	8 MA	8	185		275	11	2.200
36.60	5	10 MA	9	220		320	12	3.300
36.61	6	12 MA	12	275		390	14	5.000

D TERMINALI A GANCI
HOOK TERMINALS

Art.	Cavo Wire Ø	Ø Esterno External Ø
40.01	mm 2,5	mm 6
40.02	mm 3	mm 6

E TERMINALI A "T"
"T" TERMINALS

Art.	Cavo Wire Ø	Ø Esterno External Ø
41.02	mm 2,5	mm 6
41.03	mm 3	mm 6
41.05	mm 4	mm 8
41.06	mm 5	mm 10

F TERMINALI SNODATI A FORCELLA
TOGGLE FORK TERMINALS

Art.	Cavo Wire Ø	Perno Pin Ø	Ø Esterno External Ø
42.01	mm 2,5	mm 6	mm 6
42.02	mm 3	mm 6	mm 6
42.03	mm 4	mm 8	mm 8
42.04	mm 5	mm 10	mm 10

G TERMINALI A OCCHIO
EYE TERMINALS

Art.	Cavo Wire Ø	Ø Esterno External Ø
43.02	mm 2,5	mm 6
43.03	mm 3	mm 6
43.05	mm 4	mm 8
43.06	mm 5	mm 10

H TERMINALI FILETTATI
THREAD TERMINALS

Art.	Cavo Wire Ø	Filettatura Thread	Ø Esterno External Ø
44.02	mm 2,5	5 MA	mm 5
44.03	mm 3	6 MA	mm 6
44.05	mm 4	8 MA	mm 8
44.06	mm 5	10 MA	mm 10

Tenditori
> Terminali

AISI 316

Riggings screws
> Swage terminals

AISI 316



NEW!
NUOVO!