

MOSCHETTONI IN ACCIAIO INOX STAINLESS STEEL CARBINE - HOOKS

Art.	Ø mm	IN.	lung. mm	length IN.	Carico di rottura Kg Breaking load Kg
29.01	4	5/32	40	1 37/64	170
29.02	5	3/16	50	2	280
29.03	6	1/4	60	2 3/8	320
29.04	7	17/64	70	2 3/4	450
29.05	8	5/16	80	3 3/16	800
29.06	10	3/8	100	4	1.200
29.07	12	7/16	140	5 1/2	1.600

Art.	Ø mm	IN.	lung. mm	length IN.	Carico di rottura Kg Breaking load Kg
29.11	4	5/32	40	1 37/64	170
29.12	5	3/16	50	2	280
29.13	6	1/4	60	2 3/8	320
29.14	7	17/64	70	2 3/4	450
29.15	8	5/16	80	3 3/16	800
29.16	10	3/8	100	4	1.200

Art.	lung. mm	length IN.	Carico di rottura Kg Breaking load Kg
29.20	50	2	200
29.21	70	2 3/4	330
29.22	100	4	950

lung. mm	Ø B mm	Ø A mm	Art.	Ø A IN.	Ø B IN.	length IN.	Carico di rottura Kg Breaking load Kg
70	15	13	29.35	1/2	9/16	1 3/4	600
87	20	14	29.36	9/16	13/16	3 27/64	900
124	30	22	29.37	7/8	13/16	4 7/8	1700

Moschettone inox microfuso ad apertura totale con occhio girevole
Stainless steel snap shackle with swivel eye

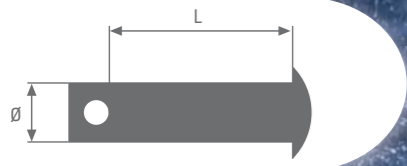

A PERNETTI FORATI - CLEVIS PINS AISI 316

CONFEZIONE 30 PZ.
BOX 30 PCS

Art.	mm	Ø IN.	mm	L IN.
30.15	4	5/32	10	3/8
30.16	4	5/32	13	1/2
30.17	4	5/32	25	1
30.22	4	5/32	16	5/8
30.01	5	3/16	10	3/8
30.02	5	3/16	12	1/2
30.03	5	3/16	15	9/16
30.04	5	3/16	18	11/16
30.05	5	3/16	20	13/16
30.32	5	3/16	21	53/64
30.33	5	3/16	24	15/16

Art.	mm	Ø IN.	mm	L IN.
30.06	6	1/4	10	3/8
30.07	6	1/4	12	1/2
30.08	6	1/4	15	9/16
30.09	6	1/4	18	11/16
30.10	6	1/4	20	13/16
30.11	6	1/4	22	7/8
30.12	6	1/4	25	1
30.13	7	17/64	15	9/16
30.18	8	5/16	13	1/2
30.14	8	5/16	18	11/16
30.19	10	3/8	17	11/16

B ANELLINI INOX - S/S SAFETY RINGS

CONFEZIONE 100 PZ.
BOX 100 PCS

Art.	mm	Ø IN.	Filo/Material Ø mm
31.01	13	1/2	0,8 [X2]
31.02	17	11/16	1 [X2]
31.03	18	11/16	1,2 [X2]

C RIVETTI INOX - S/S RIVETS

CONFEZIONE 100 PZ.
BOX 100 PCS

● A taglio ● Shear strength
● A trazione ● Tensile strength

Art.	Ø mm	IN.	Lunghezza sottotesta mm	Length Under head IN.	Spessori rivettabili mm	For thickness IN.	Carico di rottura Breaking load Kg
33.02	4	5/32	10	3/8	4 - 6	5/32 - 1/4	● 270 - 350 ●
33.03	4	5/32	12	1/2	6 - 8	1/4 - 5/16	● 270 - 350 ●
33.04	4	5/32	14	9/16	8 - 10	5/16 - 3/8	● 270 - 350 ●
33.05	5	3/16	10	3/8	4 - 5	5/32 - 3/16	● 420 - 550 ●
33.06	5	3/16	12	1/2	6 - 8	1/4 - 5/16	● 420 - 550 ●
33.07	5	3/16	16	5/8	10 - 12	3/8 - 1/2	● 420 - 550 ●



▶ MOSCHETTONI IN ACCIAIO INOX
▶ PERNETTI FORATI

▶ ANELLINI INOX
▶ RIVETTI INOX
AISI 316



▶ STAINLESS STEEL CARBINE-HOOKS
▶ CLEVIS PINS

▶ S/S SAFETY RINGS
▶ S/S RIVETS
AISI 316

